

Elexant Connect Application

Raychem

User Manual

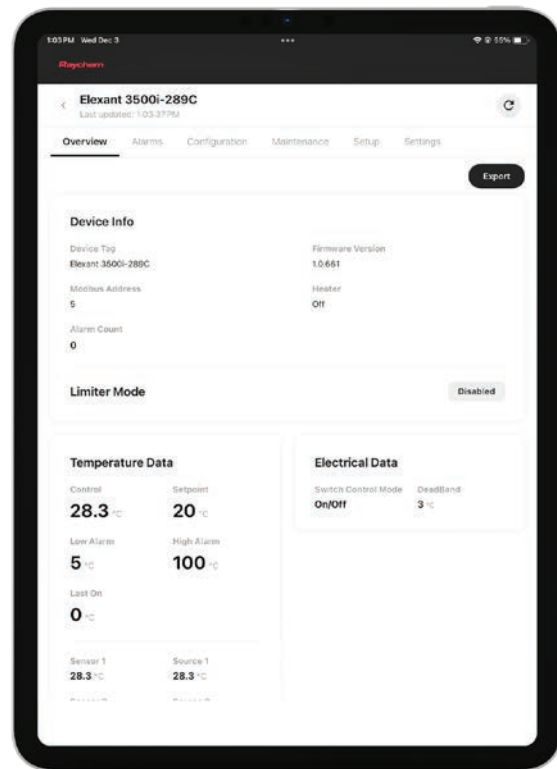
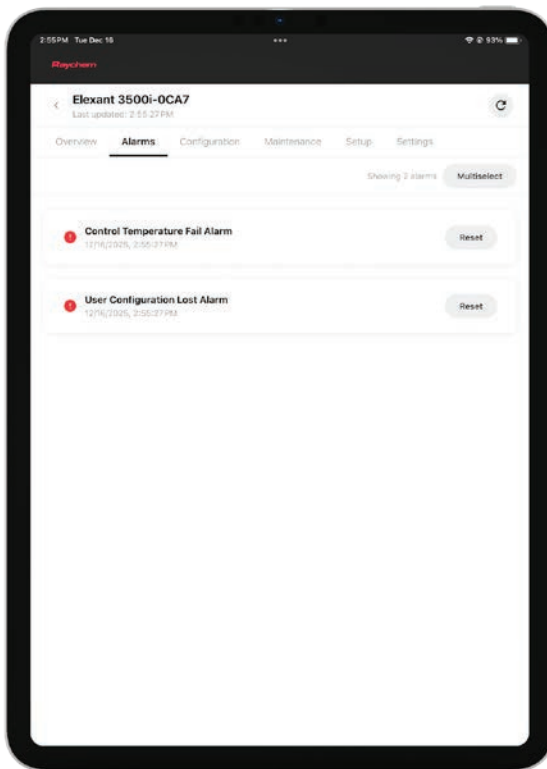

Table of Content

Section 1 – Product Overview	3
1.1 Elexant Connect User Manual - Vital information	3
1.2 Elexant Connect - License Agreement	3
Section 2 – How to Run the Elexant Connect Application	8
Section 3 – Initial Setup of the Unit	9
3.1 Main Screen	11
3.2 App Toolbar.....	11
3.2.1 App Settings	11
3.2.2 Support.....	12
3.2.3 About	12
3.3 Tools	13
3.3.1 Firmware Update Screen.....	13
3.3.2 Reset Device Password.....	14
3.4 Manage Device Pairings	15
3.4.1 Scanning for Nearby Devices	15
3.4.2 Fetching Data from Scanned Devices	15
3.4.3 Remove a Device.....	16
3.4.4 Re-fetch Device Data	16
Section 4 – Screen Layout	17
4.1 Top Section Screen.....	17
4.1.1 Device Settings.....	17
4.2 Device Tabs	18
Section 5 – Overview Screen	19
Section 6 – Alarm Screen	2
Section 7 – Configuration - General Screen	21
7.1 General Settings	21
7.2 SIM Utility Settings.....	22
7.3 Communication Settings.....	23
7.4 Advanced Settings.....	24
7.5 Import / Export Configuration	24
Section 8 – Bluetooth Security	25
8.1 Bluetooth® Security.....	25
8.1.1 Enabling Bluetooth® Security.....	25
8.1.2 Unlocking a Device.....	26
8.1.3 Reset Device	27

SECTION 1 – PRODUCT OVERVIEW

This document describes the use and the capabilities of the Raychem Elexant Connect application.

Raychem Elexant Connect configuration and monitoring software is developed for Android version 11 and upwards as well as iOS version 15 and upwards. The software enables Raychem TraceTek TTSIM3/4 devices to be configured and monitored via a Wireless Bluetooth interface. The exact use of this software is described in this manual.

1.1 ELEXANT CONNECT USER MANUAL - VITAL INFORMATION

This manual is a guide for the setup and operation of the Elexant Connect application (formerly the Field Connect application).

Important: All information, including illustrations, is believed to be reliable. Users, however, should independently evaluate the suitability of each product for their particular application. Chemelex makes no warranties as to the accuracy or completeness of the information and disclaims any liability regarding its use. Chemelex's only obligations are those in the Chemelex Standard Terms and Conditions of Sale for this product, and in no case will Chemelex or its distributors be liable for any incidental, indirect, or consequential damages arising from the sale, resale, use, or misuse of the product. Specifications are subject to change without notice. In addition, Chemelex reserves the right to make changes—without notification to Buyer—to processing or materials that do not affect compliance with any applicable specification.

1.2 ELEXANT CONNECT - LICENSE AGREEMENT

Terms and Conditions for “Elexant Connect”

This end-user license agreement (“EULA”) is between you (referred to as “You” or “Your”) and Chemelex LLC, 15375 Memorial Dr, Houston TX 77079, United States (the “Company”) who owns the application software named “Elexant Connect” (the “App”) through which You can, amongst other things, configure and monitor the Raychem Elexant 5010i Heat-Tracing Control Units, Elexant 3500i Electronic Thermostat and Raychem TraceTek TTSIM-3/4 (the “Units”). The Company licenses use of the App to You subject to the terms of this EULA. This App requires an Android device or an iOS device or a Windows PC device with a minimum of 100MB of memory (the “Device”). The App also requires internet access in order to be downloaded and/or to get the updates the Company might release from time to time. The App also requires an Android operating system of 11.0 and upwards or iOS version 15 and upwards or Windows version of 10 and upwards and a minimum screen resolution of 800 x 480 for Android / iOS device or 1024 x 700 for Windows device. You are responsible for making all arrangements necessary to ensure You have access to the App. This App will be available and can be accessed in any country, except for Restricted Countries subject to economic sanctions and constraints administered by the U.S. Treasury Department, or applicable export control measures administered by the U.S. Department of Commerce and U.S. Department of State, or any other government agencies. This App will only be supported by the Company in English. This means that if You require support to use this App, you must be able to communicate with the Company in English. The Company does not file a copy of this EULA. You should print a copy of this EULA for future reference.

Important Notice

By installing, downloading or streaming the App or any portion of the App You agree to the terms of this EULA which will legally bind You. If You are performing any of the foregoing on behalf of a company or other entity, “You” means that entity, and you are binding that entity to this EULA. You represent and warrant that you have the legal power and authority to enter into this EULA and that, if the licensee is an entity, this EULA is entered into by an employee or agent with all necessary authority to bind that entity to this EULA. If You do not agree to the terms of this EULA, You must not use the App and stop the installation, downloading or streaming process now. If the App was downloaded or otherwise installed, please destroy all copies of the App.

1. AGREED TERMS

Your use of the App and Company warranties

- 1.1 In consideration of You agreeing to comply with the terms of this EULA, the Company grants You a non-transferable, nonassignable, non-exclusive and revocable license to use the App on the Device, subject to this EULA and the Privacy Policy, incorporated into this EULA by reference. The Company reserves all other rights.
- 1.2 You agree that:
 - (a) You are solely responsible for any use of the App, including (without prejudice to clauses 3.2 and 11.2) any other user that You permit to use the App on the Device; and
 - (b) the Company shall not be liable to any user that You permit to use the App on the Device; and
 - (c) You are responsible for Your actions or those of any user that You permit to use the App on the Device.
- 1.3 You may install, download or stream a copy of the App onto the Device and view, use and display the App on the Device for (when the App is properly used in accordance with this EULA and on an operating system for which it was designed):
 1. configuring and monitoring the Raychem Elexant 5010i Heat Tracing Control Units, the Elexant 3500i Electronic Thermostat

and the Raychem TraceTek TTSIM-3/4 (the "Units"); and 2. updating the firmware of the Units.

- 1.4 You may not re-download or copy the App content. Features of the App may be available on a limited or temporary basis.
- 1.5 At the Company's sole discretion downloadable App content may be cancelled and/or no longer made available and in such circumstances the Company shall be under no obligation to ensure Your use of the App or App content (as the case may be) is resumed or that You are able to re-download the App content. Examples of this include (without limitation) limited availability in accordance with clause 1.4.

2. ACKNOWLEDGMENTS

You acknowledge and agree that:

- 2.1 the terms of this EULA apply to the App including any updates or supplements to the App unless such updates or supplements come with separate terms, in which case those terms apply;
- 2.2 from time to time updates to the App may be issued by the Company. Depending on the update, You may not be able to use the App until You have downloaded or streamed the latest version of the App;
- 2.3 You will be assumed by agreeing to the terms of this EULA to have obtained permission from the owners of the mobile telephone or handheld Device that is controlled, but not owned, by You to download, install or stream a copy of the App onto the Device. You and they may be charged by Your and their service providers for internet access on the Device. You accept responsibility in accordance with the terms of this EULA for the use (whether the use is by You or the owner of the Device) of the App on or in relation to any Device, whether or not it is owned by You and for any charges levied by service providers for Your use or the owner's use of the App on the Device;
- 2.4 the App specifications may be changed without prior notice;
- 2.5 the App is provided "as is" and no guarantee, implied or express, is provided by the Company should there be any error, data loss or any other event causing malfunction whatsoever;
- 2.6 the App is only to be used as a tool to assist with monitoring the Units and You must separately monitor (and continue to monitor) the Units in accordance with Your current procedures and the Company's instructions; and
- 2.7 subject to clause 7.1, all warranties, conditions and other terms implied by law (whether by statute, common law or otherwise) are excluded from this EULA.

3. LICENSE RESTRICTIONS

Except as expressly set out in this EULA or as permitted by applicable law, as part of the license from the Company to You at clause 1.1, You agree:

- 3.1 not to copy the App except where such copying is incidental to normal use of the App, or where it is necessary for the purpose of back-up or operational security;
- 3.2 not to rent, lease, transfer, assign, license, sub-license, loan (or otherwise distribute), distribute, translate, merge, adapt, sell, resell, reproduce, copy, publish the App or disclose the App to third-parties or otherwise commercially exploit the App or make it, or any portion thereof, available to any third party in any manner;
- 3.3 not create derivative works based on the App;
- 3.4 not copy any ideas, features, functions or graphics of the App;
- 3.5 not remove, obscure, alter or move the Company's and/or its licensors' proprietary notices;
- 3.5 not to make alterations to, or modifications of, the whole or any part of the App, or permit the App or any part of it to be combined with, or become incorporated in, any other programs;
- 3.6 not to disassemble, decompile, attempt to derive the source code or reverse-engineer the App (except to the extent that applicable laws prohibit reverse engineering restrictions, and then only as permitted by such laws);
- 3.7 not to use the App to violate, tamper with or circumvent the security of any computer network, software, passwords or otherwise engage in any illegal activity or enable others to do so;
- 3.8 keep all copies of the App secure and to maintain accurate and up-to-date records of the number and locations of all copies of the App; and
- 3.9 to include the Company's copyright notice on all entire and partial copies You make of the App on any medium.

4. APP USE RESTRICTIONS

When using the App You must and (without prejudice to clauses 3.2 and 11.2) You shall procure that other users of the App on the Device must:

- 4.1 not use the App in any unlawful manner, for any unlawful purpose, or in any manner inconsistent with this EULA, or act fraudulently or maliciously, for example, by hacking into or inserting malicious code, including viruses, or harmful data, into the App or any operating system; not use the App in a way that could damage, disable, overburden, impair or compromise the Company's systems or security or interfere with other users; not collect or harvest any information or data from the Company's systems or attempt to decipher any transmissions to or from the servers running any service; not take any activity which infringes upon (or has the risk of infringing upon) the intellectual property rights (such as the design rights) of the Company or any third party in relation to Your use of the App; not carry out any activity which infringes upon (or has the risk of infringing upon) the assets, the privacy, and the rights to usage of one's likeness belonging to the Company or any third party; not carry out any activity which unjustly prejudices and/or slanders the Company or any third party and/or any activity which damages the reputation and/or trustworthiness of the Company or any third party; not carry out any activity connected to (or has the risk of being connected to) fraud or any other criminal activity; not carry out any other activity which is against the law, is a violation of public order and standards of decency, or which infringes upon the rights of another user or other third party; and not carry out any other activity which could be deemed unsuitable by the Company.

5. INTELLECTUAL PROPERTY RIGHTS

- 5.1 You acknowledge and agree that all rights, title and interest, including all intellectual property rights in the App and its content anywhere in the World belong exclusively to the Company and that rights in the App are licensed, and not sold, to You and that You have no rights in, or to, the App or its content other than the right to use the App in accordance with the terms of this EULA.
- 5.2 You acknowledge and agree that You have no right to have access to the App in source-code form.
- 5.3 "Feedback" means all observing, evaluative or corrective information, statement, comment or observation about an incident, action, event, or process and other content or items prepared or otherwise provided by You to the Company in relation to the App. During the course of using the App, You may provide Feedback to the Company. The Company shall exclusively own all rights, title and interest, including all Intellectual Property Rights, in this Feedback. In the event that any Intellectual Property Rights in Feedback is deemed for any reason not to be exclusively owned by the Company, You agree to assign, transfer and convey to the Company, and hereby assign, transfer and convey to the Company, all right, title and interest, including Intellectual Property Rights, in such Feedback, and agree to provide reasonable cooperation to the Company, at the Company's expense, to perfect such rights.

6. DATA COLLECTION POLICY

- 6.1 In order to provide You with information tailored to Your interests, the Company may use the data You enter into the App.
- 6.2 The Company will only use Your data for research and analysis purposes and such use will be subject to the Company's Privacy Policy. For more information on how the Company may process that information, who the Company may share it with and Your rights to this data, a copy of the Privacy Policy can be obtained by emailing to privacy@chemelex.com.
- 6.3 By agreeing to the terms of this EULA by installing, downloading or streaming the App You consent to such processing and You confirm that all data provided is accurate and contains the necessary permissions.

7. COMPANY'S LIABILITY TO YOU

- 7.1 Nothing in this clause 7 or this EULA shall limit or exclude the Company's liability to You for:

- (a) death or personal injury resulting from the Company's negligence;
- (b) fraud or fraudulent misrepresentation; and
- (c) any other liability that cannot be excluded or limited by applicable law.

7.2 DISCLAIMERS

- 7.2.1 You expressly acknowledge that your use of the App is at your sole risk. The Company provides you the App "as is" and "as available", with all faults and defects, without warranty and without maintenance or support services. The Company makes no representations or warranties of any kind, and the Company disclaims all warranties and representations whether express, implied, statutory or otherwise with respect to the App, including, without limitation any warranty:

- (a) that the App will be compatible with all or any hardware and software which You may use, except a Device;
- (b) that the App will be available at all times and will operate uninterrupted and be error free, virus free and secure;
- (c) of merchantability, of fitness for a particular purpose, of satisfactory quality, of non-infringement, of quiet enjoyment,
- (d) related to the integrity, timeliness, reliability, and/or accuracy of the App; or

(e) that the App will necessarily work on the Device, even if Your Device meets all the operational and technical requirements.

7.2.2 Technical issues and updates are controlled by the Company. However, the Company is not liable or responsible for updating or maintaining Your personal licensed App copy.

7.3 LIMITATION OF LIABILITY

7.3.1 You acknowledge that the App has not been developed to meet Your individual requirements, and that it is therefore Your responsibility to ensure that the facilities and functions of the App as described in this EULA meet Your requirements.

7.3.2 Notwithstanding anything to the contrary and to the maximum extent permitted by applicable law, the Company will have no liability to You for any loss of profit, loss of business, loss of data, business interruption, or loss of business opportunity costs of substitute goods or services, or any indirect, consequential or special loss.

7.3.3 If the Company fails to comply with the terms of this EULA, the Company is only responsible for loss or damage You suffer that is a foreseeable result of the Company's breach of this EULA or the Company's negligence up to the limit specified at clause 7.3.4 but the Company is not responsible for any unforeseeable loss or damage. Loss or damage is foreseeable if it is an obvious consequence of the Company's breach or if they were contemplated by You and the Company at the time the Company granted You the license under this EULA.

7.3.4 The Company's (together with its affiliates) maximum aggregate liability to You (together with your affiliates) under or in connection with this EULA whether in contract, tort (including without limitation negligence) or otherwise, shall in all circumstances be limited to 2000 EUR in aggregate.

8. TERMINATION

You may terminate this EULA by ceasing use of the App and uninstalling the App. The Company may terminate this EULA (in whole or in part) at any time with immediate effect on written notice to You:

1. if You are in breach of this EULA;
2. if You give the Company false information or withhold from the Company important information in relation to Your use of the App;
3. if You breach the License Restrictions or App Use Restrictions at clauses 3 and 4 respectively;
4. if You attempt to defraud the Company or act dishonestly;
5. if the App is no longer provided or supported by the Company or its affiliates; or
6. if required to do so by applicable law or regulation, and/or if there is a change in the applicable law that would have a material impact (including a cost impact) on the provision of the App.

Where the Company terminates Your EULA, all license rights granted to You shall immediately terminate and You must cease use of the App, uninstall the App immediately and provide confirmation of the same to the Company in writing (if requested by the Company). Termination will not limit any of Chemelex's rights or remedies at law or in equity. You are responsible to save and export the data you enter into the App regularly. After termination of this EULA, the Company may delete the data you have entered in the App.

9. COMMUNICATION BETWEEN US AND ENQUIRIES

9.1 Communications

- (a) The Company reserves the right, at any time and from time to time, to update, revise, supplement, and otherwise modify this EULA, for example but not limited to, to comply with changes in the law or to take account of new functionalities of the App that the Company may offer. Such updates, revisions, supplements and other modifications will be effective immediately upon publication. Your continued use of the App will be deemed to constitute Your acceptance of such updates, revisions, supplements and other modifications. If you do not agree to any such updates, revisions, supplements and other modifications, please discontinue using the App and uninstall the App.
- (b) The Company will not necessarily bring changes or updates to Your attention other than in accordance with clause 9.1(a). It is therefore important that You read the terms of this EULA each time You install, download or stream the App to ensure that You are aware of any changes and that You agree to any changes.
- (c) If You wish to contact the Company in writing, or if any condition in this EULA requires You to give the Company notice in writing, You can send this to us by e-mail to info@chemelex.com or by prepaid post to Chemelex Europe GmbH, with registered office at Grabenstrasse 15, 8200 Schaffhausen, Switzerland. The Company will confirm receipt of this by contacting You in writing, normally by e-mail. Please ensure that Your email address is provided.

9.2 Enquiries

If You have any questions regarding this App, wish to report a bug, or if You have additional features You would like to recommend for this App please contact the Company at: info@chemelex.com

10. EVENTS OUTSIDE OF THE COMPANY'S CONTROL

- 10.1 The Company will not be liable or responsible for any failure to perform, or delay in performance of, any of its obligations under this EULA that is caused by any act or event beyond the Company's reasonable control including but not limited to failure of public or private telecommunications networks, acts of God, flood, drought, earthquake or other natural disaster; epidemic or pandemic; terrorist attack, civil war, cyberattacks, civil commotion or riots, war, threat of or preparation for war, armed conflict, imposition of sanctions, embargo, or breaking off of diplomatic relations; any Laws or any action taken by a government or public authority, including without limitation imposing an export or import restriction, quota or prohibition; collapse of buildings, fire or explosion; and any labor or trade dispute, strikes, industrial action or lockouts ("Event Outside the Company's Control").
- 10.2 If an Event Outside the Company's Control takes place that affects the performance of the Company's obligations under this EULA: (a) the Company's obligations under this EULA will be suspended and the time for performance of its obligations will be extended for the duration of the Event Outside the Company's Control.

11. OTHER IMPORTANT TERMS

- 11.1 The Company may at any time assign, transfer, mortgage or deal in any other manner with all or any of its rights and obligations under this EULA.
- 11.2 You may only transfer Your rights or obligations under this EULA to another person if the Company agrees in writing.
- 11.3 Subcontracting. Subject to mandatory applicable Laws, the Company shall be permitted to subcontract or delegate in any manner any or all of the performance of its obligations under the EULA to any Affiliate, contractor or any other third party service provider without requiring Your prior written consent.
- 11.4 If the Company fails to insist that You perform any of Your obligations under this EULA, or the Company does not enforce its rights against You, or the Company delays in doing so, that will not mean that the Company has waived its rights against You and will not mean that You do not have to comply with those obligations.
- 11.5 This EULA and all documents referred to herein constitute the entire agreement between You and the Company and supersede any prior agreement or arrangement in respect of its subject matter and neither party has entered into this EULA in reliance upon, and it will have no remedy in respect of, any misrepresentation, representation or statement (whether made by the other party or any other person) which is not expressly set out in this EULA or in the documents referred to herein. Nothing in this clause will be interpreted or construed as limiting or excluding the liability of either party for fraud or fraudulent misrepresentation.
- 11.6 Each of the conditions of this EULA operates separately. If any court or competent authority decides that any of them are unlawful or unenforceable, the remaining conditions will remain in full force and effect.
- 11.7 Any affiliate of the Company may seek to enforce the terms of this EULA to the extent they confer a benefit upon it. Otherwise, none of the terms of this EULA shall be enforceable under the Contract (Rights of Third Parties) Act 1999 by any third party and no other person therefore shall have any rights to enforce any of the terms of this EULA between You and the Company.
- 11.8 Please note that this EULA and any non-contractual obligations arising out of or in connection with it are governed by English law. You and the Company agree that the courts of England and Wales will have exclusive jurisdiction to determine any dispute arising out of or in connection with this EULA (including in relation to any non-contractual obligations).

United States

15375 Memorial Dr.
Houston, TX 77079
Tel: +1 713 868 4800

Belgium

Romeinse straat 14
3001 Leuven
Tel: +32 16 213 511

SECTION 2 – HOW TO RUN THE ELEXANT CONNECT APPLICATION

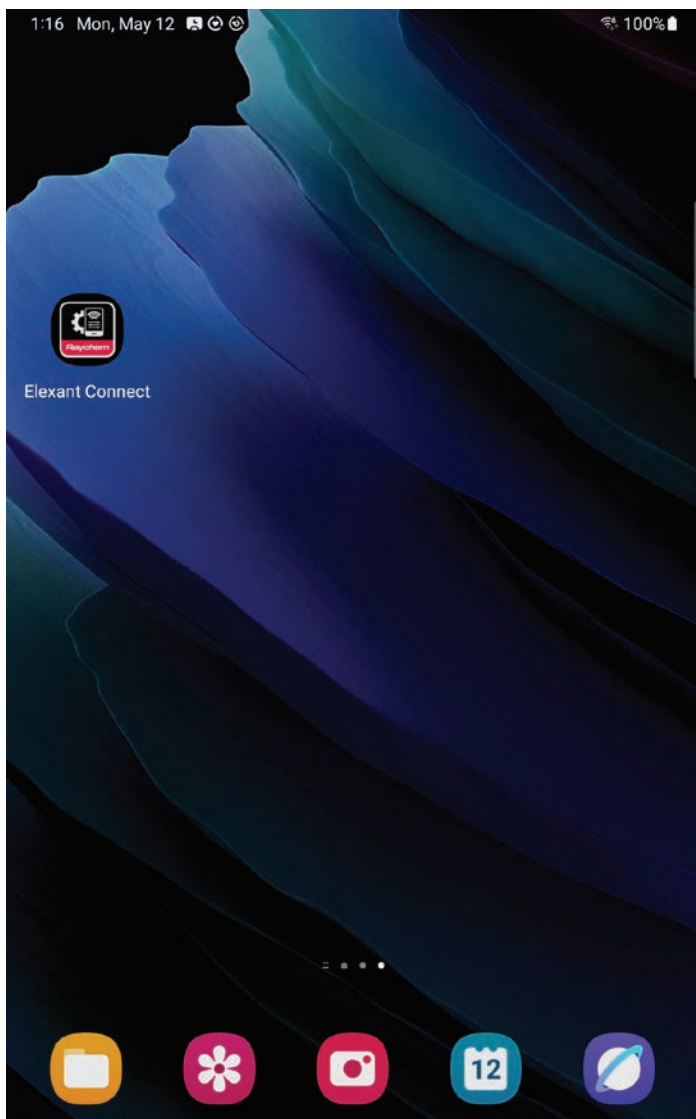

Click on the icon of the Elexant Connect application

SECTION 3 – INITIAL SETUP OF THE UNIT

After the program starts, the Startup screen (**Fig 1**) will be displayed. If it is the first time opening the app, you will be prompted to enter the application Unlock Code (**Fig 2**). Please contact your Chemelex Technical Support team to get the unlock code. Enter the Unlock Code and click on the “Unlock” button. You will also be prompted to review and accept the Terms and Conditions (**Fig 3**) to use the app.



Figure 1: Startup screen

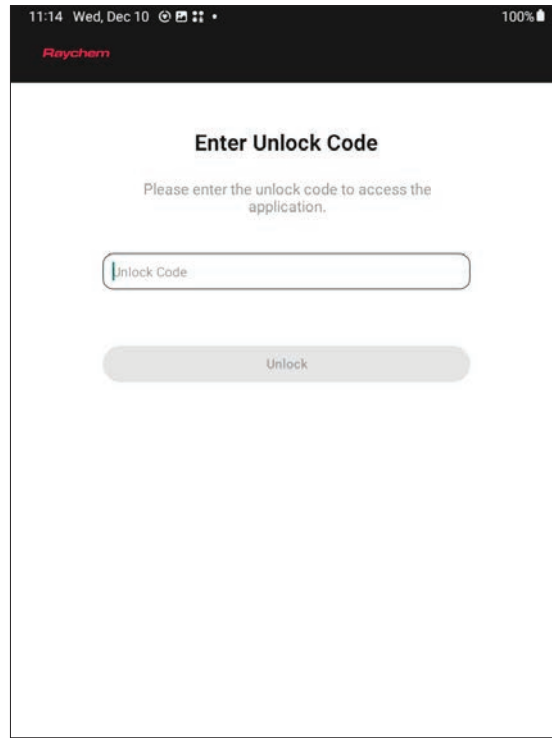

Figure 2: Unlock code screen

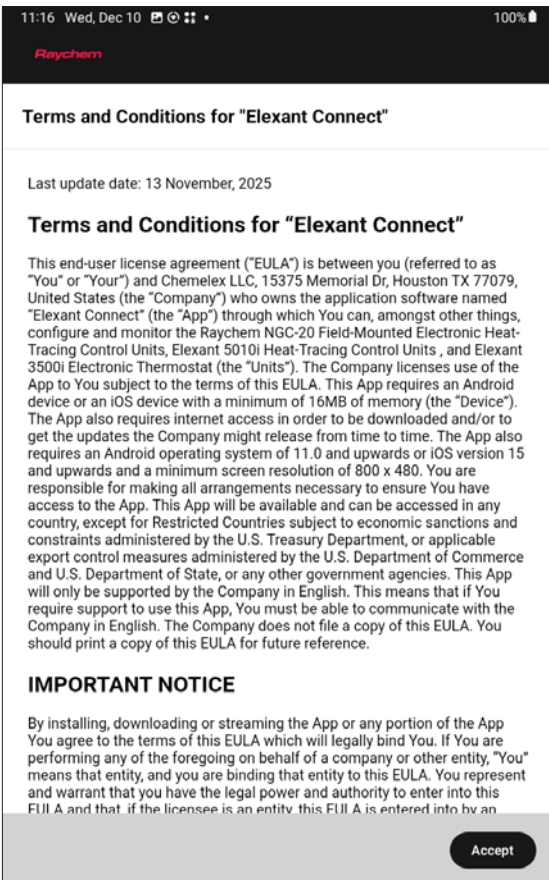

Figure 3: Terms & Conditions

Ensure that the device location sharing (**Fig 4**) and Bluetooth (**Fig 5**) are enabled as these are required to use most features of the application.

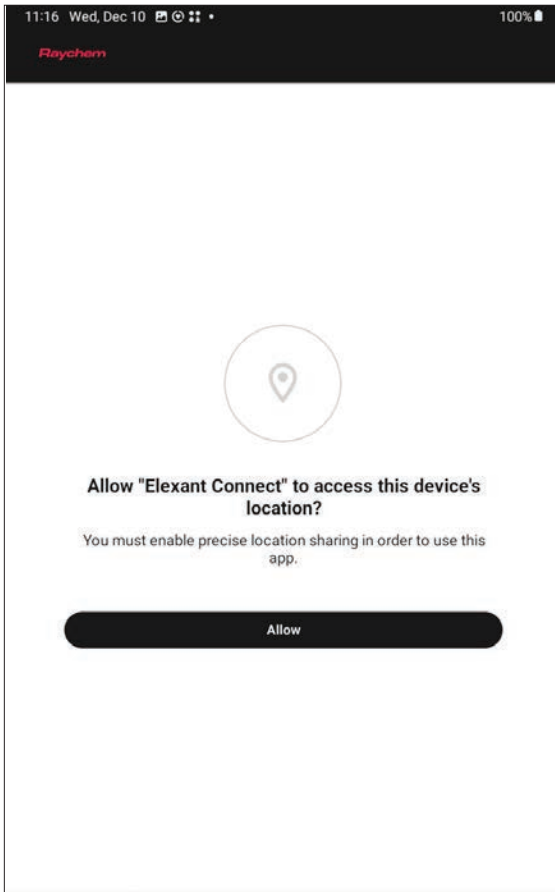

Figure 4: Device location sharing screen

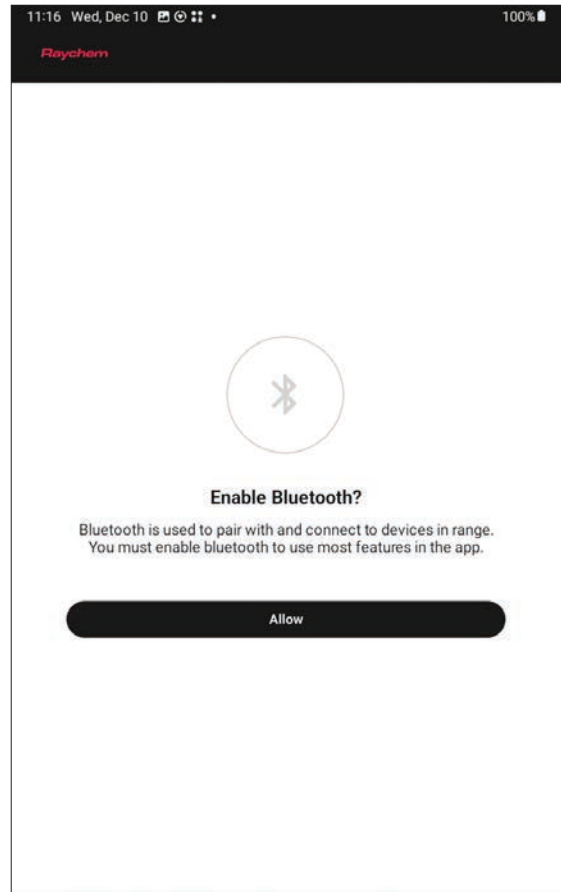

Figure 5: Enable Bluetooth screen

All the app sections show the most common, most used parameters of the TTSIM3/4 devices. Certain settings / parameters are relevant only to specific devices and may / may not be visible to all devices.

3.1 MAIN SCREEN

The main screen (**Fig 6**) will be blank every time you open the app. To display a list of devices you can connect to, read section 3.4.

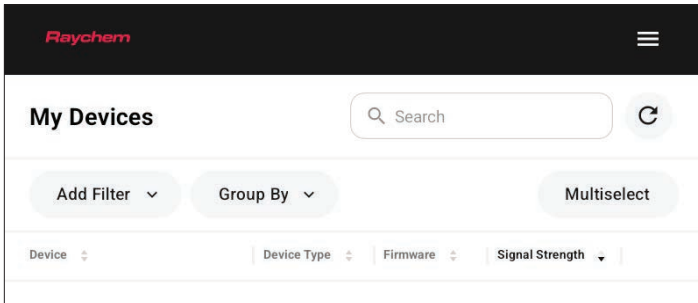

Figure 6: Main screen

There is a toolbar (3 bars) on the top right of the screen. When the toolbar is clicked, it will show Settings, Tools, Support, and About.

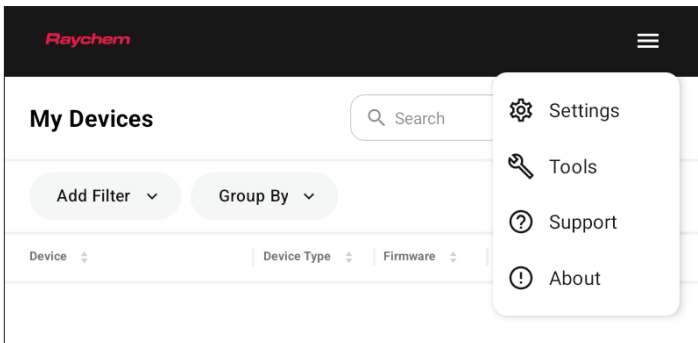

Figure 7: Main screen with 3 bars clicked

3.2 APP TOOLBAR

3.2.1 App Settings

In the Settings, the user can change Temperature, the Language the app will display as well as expand views by default.

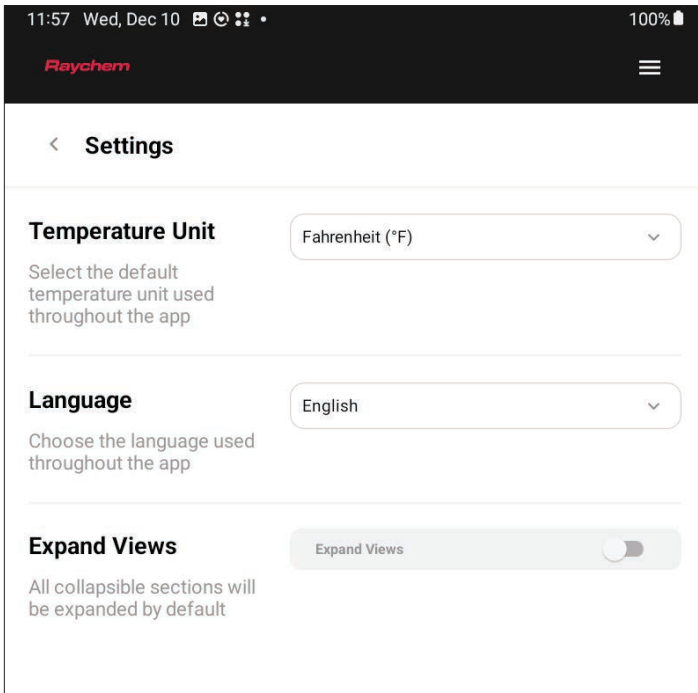

Figure 8: App Settings Screen

3.2.2 Support

Support screen (**Fig 9**) provides information on whom to contact for support questions.

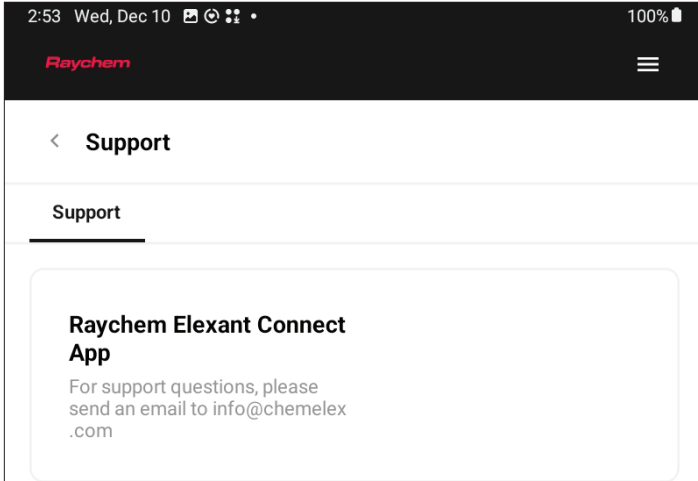

Figure 9: Support Screen

3.2.3 About

The About screen (**Fig 10**) provides basic information about the App. The Terms and Conditions (**Fig 3**) can also be accessed from this screen.

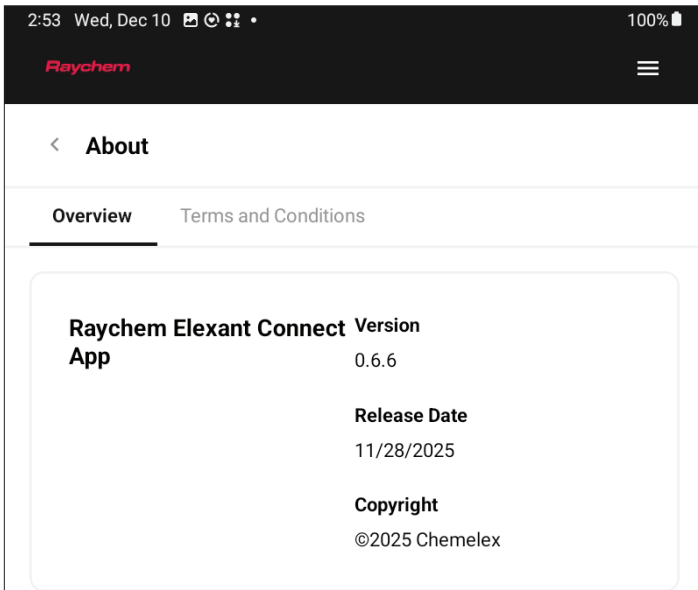

Figure 10: About Screen

3.3 TOOLS

Clicking on Tools will provide options to perform a Firmware Update or Reset Device.

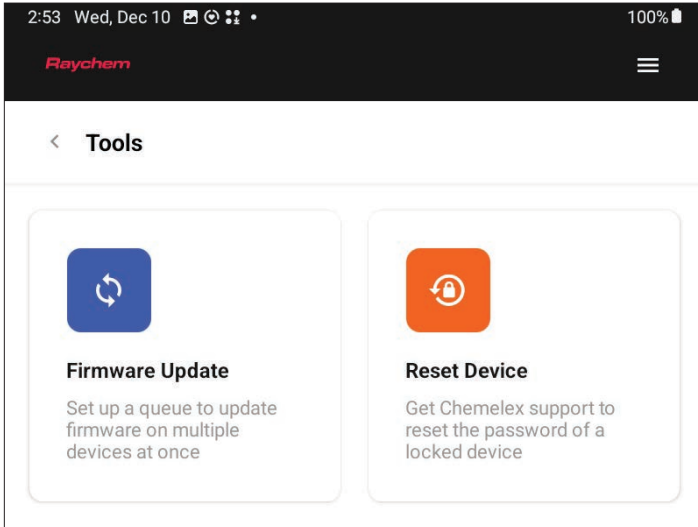

Figure 11: Tools Screen

3.3.1 Firmware Update Screen

This button will be used to update d device's firmware. Click on New update task (Fig 12).

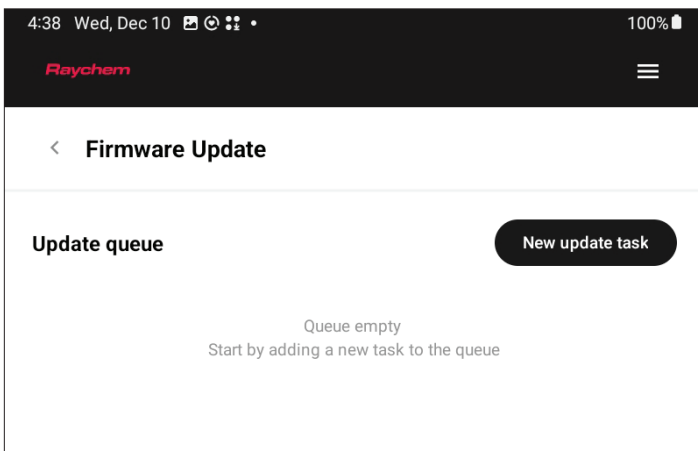

Figure 12: Firmware Update Screen

You select a file stored in the tablet running the app, which is the .bin file to update the firmware for a device (Fig 13).

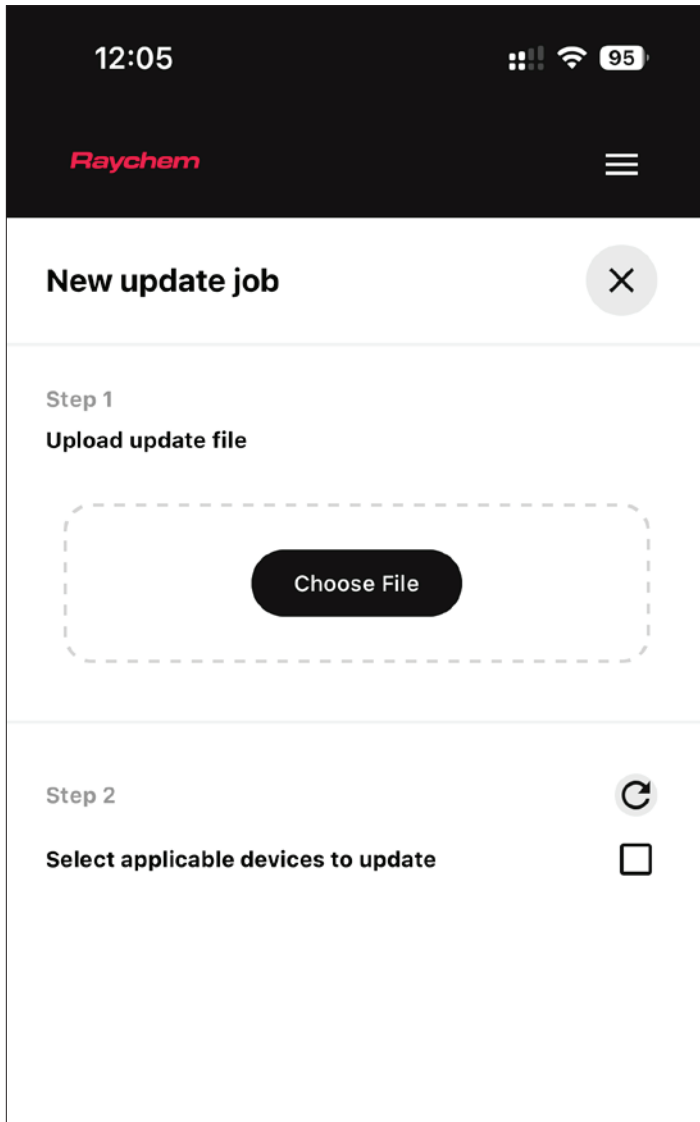

Figure 13: Firmware Update Job Screen

3.3.2 Reset Device Password

Reset Device password will be explained in Section 8.1.3. Figure 36.

3.4 MANAGE DEVICE PAIRINGS

The last button is the Refresh button.

3.4.1 Scanning for Nearby Devices

The way you can pair with TTSIM3/4 is by first scanning for devices by clicking the Refresh Button on the top right of the Main Screen. This will scan for all available Raychem devices, which might take a while depending on how many you have (**Fig 14**). Before scanning, you can filter out what device you want to see by using the Add filter dropdown. When scanning, progress info will be displayed at the bottom of the screen. This progress screen can be expanded by selecting View. From here, three things will show up on the screen after a device has been found: the device type signal strength and the MAC address for that device.

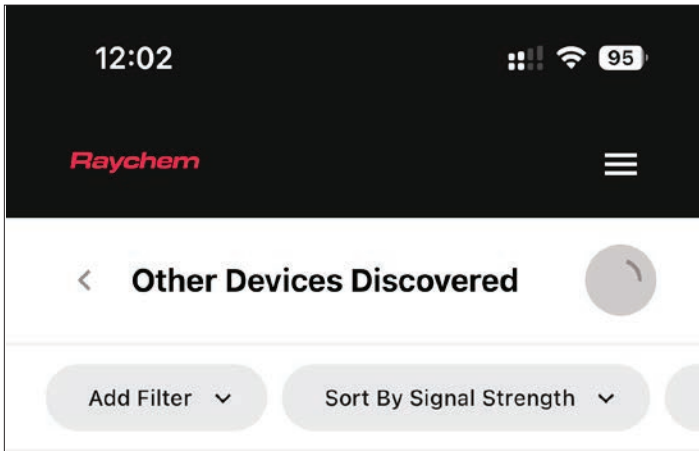

Figure 14: Scanning for Devices

3.4.2 Fetching Data from Scanned Devices

After the scanning process is done, click on the three horizontal dots associated with the specific paired device and select "Add Device" (**Fig 15a**). The app will begin fetching data for the selected devices. You can also skip the fetching process by clicking Cancel (**Fig 15b**).

When data fetching is complete the screen will look like (**Fig 16**). It will fetch the device tag and firmware version. If the device has Bluetooth security (section 8) enabled, a locked symbol will be shown.

Figure 17 shows how to filter and Figure 18 shows how to group with the Elexant Connect App.

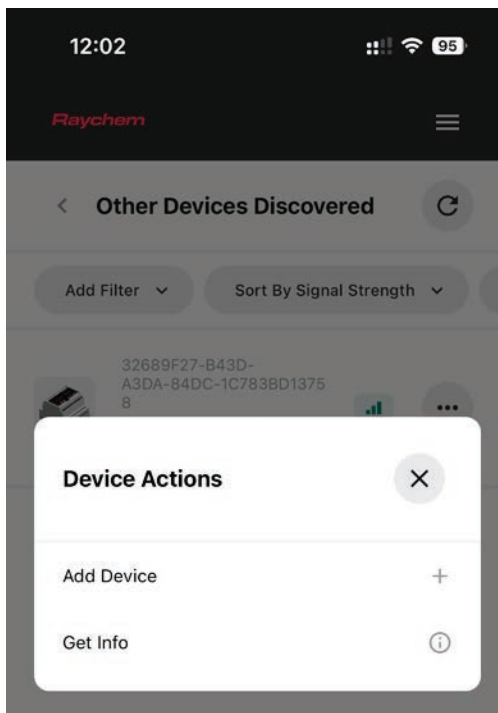

Figure 15a: Add Device

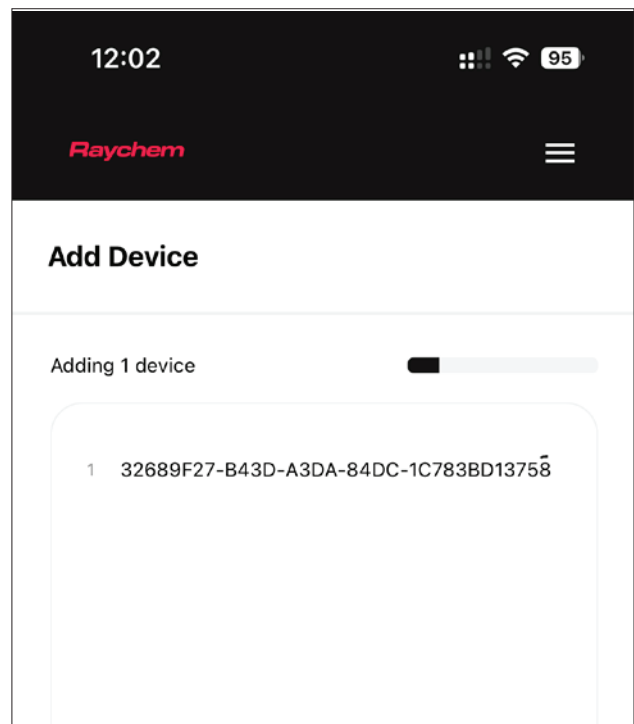

Figure 15b: Cancel Add Device

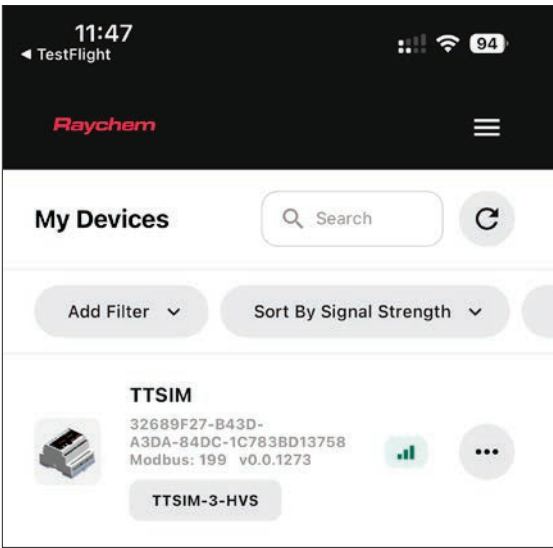

Figure 16: Devices Found

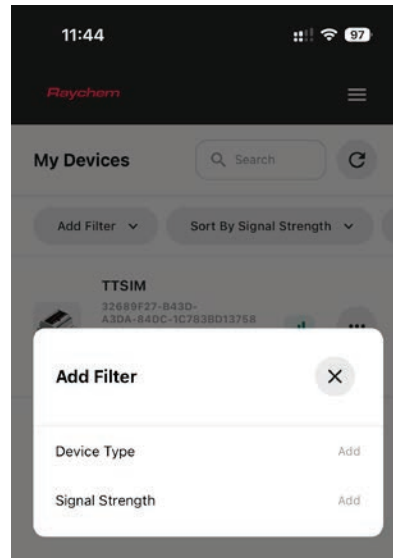

Figure 17: Filter Devices

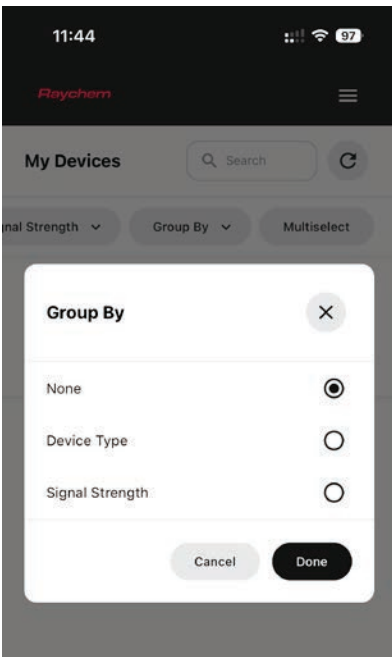

Figure 18: Group Devices

3.4.3 Remove a Device

Select the 3 horizontal dots associated with a specific paired device and clicking on Remove from My Devices disconnects the device from the application.

3.4.4 Re-fetch Device Data

Select the 3 horizontal dots associated with a specific paired device and clicking on Re-fetch Data retrieves updated data from this device.

SECTION 4 – SCREEN LAYOUT

4.1 TOP SECTION SCREEN

Each screen will show the same header information, which looks as follows. You can slide the Tab Section to see the rest of the tabs.

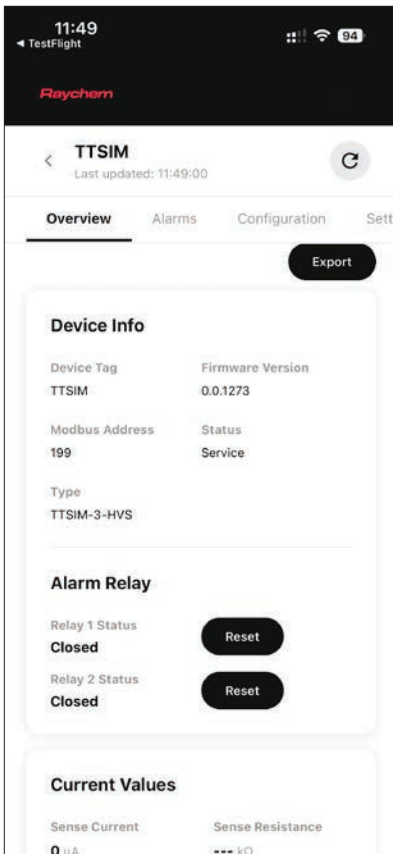

Figure 19: Top Section Application

4.1.1 Device Settings

In the Settings there will be 4 options, Security, Bluetooth, Reset Configuration and Reset RS485 Communication (**Fig 20**).

Bluetooth toggle switch allows you to enable / disable the Bluetooth functionality of the device.

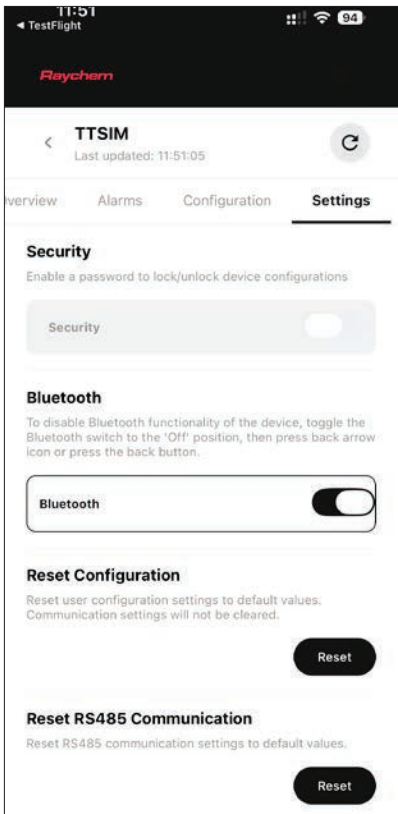

Figure 20: Device Settings Screen

4.2 DEVICE TABS

All information of the Device is displayed in separate displays. The user can select different screens for detailed overviews. The selections are:

- Overview
- Alarms
- Configuration
- Settings

The different screens display relevant information for the specific selected devices. Not all the devices will have the same information as shown in the screen.

SECTION 5 – OVERVIEW SCREEN

This overview will enable the user to have a quick overview of the Device.

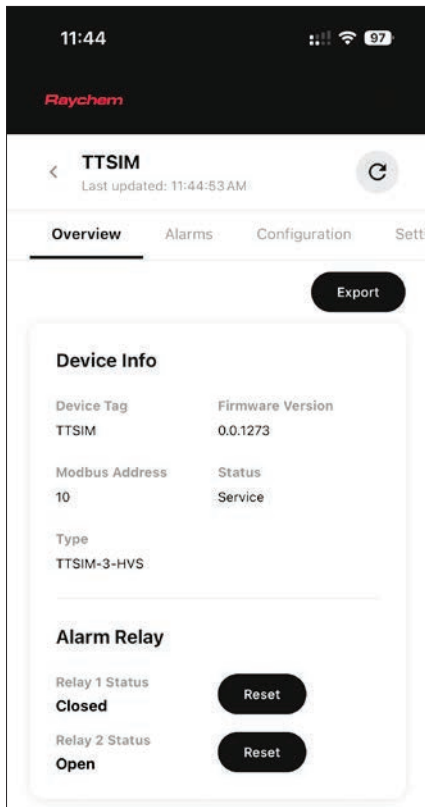

The Device Info section describes the Modbus address of the device, the device tag, firmware version of the device, the output status, the type of the unit and alarm relay 1 and 2 status.

The Current Values section presents:

- Sense Current
- Sense Resistance
- Location Resistance
- Location
- YB Resistance
- RG Resistance
- Test Length

The Alarm Threshold section includes:

- Leak Alarm
- Service Alert
- Loop Imbalance
- SIM Status (HEX)

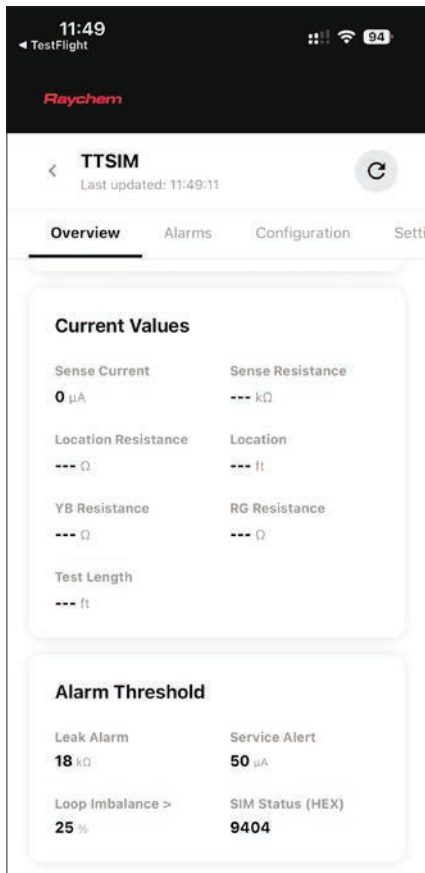

Figure 21: Overview Screen

SECTION 6 – ALARM SCREEN

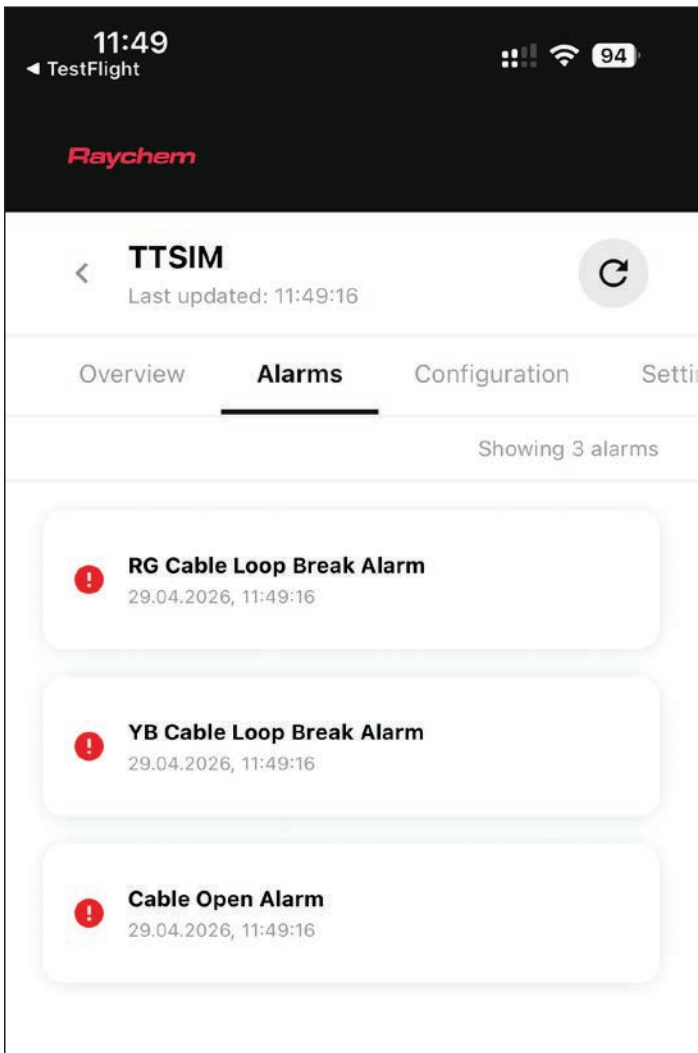

Figure 22: Alarm Overview Screen

The alarm screen shows all alarms present in the Device.

The alarm message describes:

- Time Stamp
 - The time on which the App has read that there is an alarm. It is not when the Alarm had occurred
- The Alarm Type
- The Alarm Value
 - If the Alarm has an associated Setpoint value for it, the value that would be shown is value that raised the Alarm

SECTION 7 – CONFIGURATION - GENERAL SCREEN

The Configuration tab presents all data available in the device related to general settings, alarm relay settings, communication settings and advanced settings.

7.1 GENERAL SETTINGS

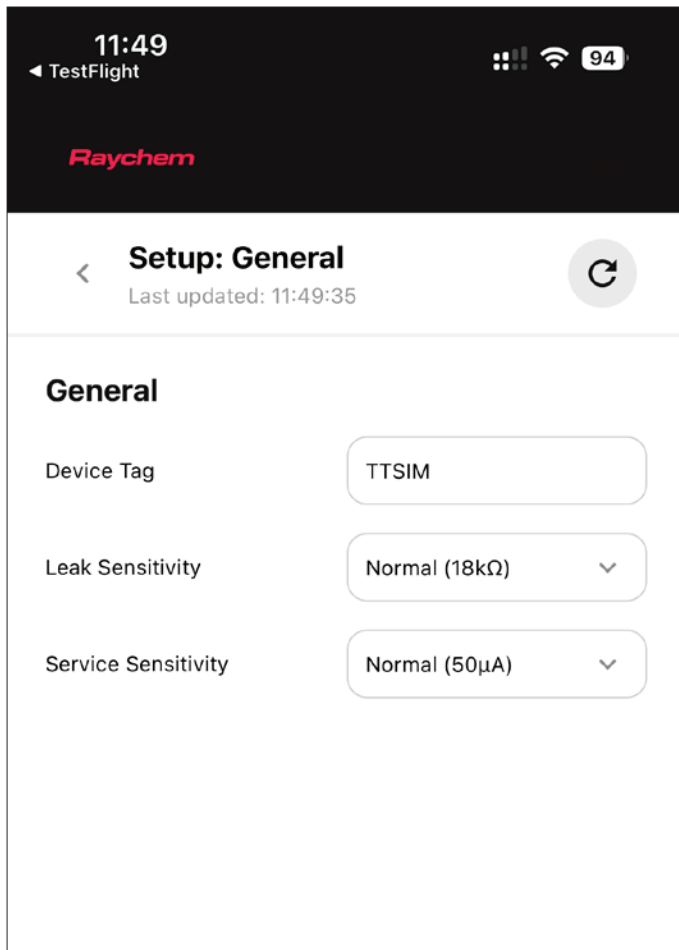

Figure 23: Temperature Control Screen

Device Tag:

Possibility to change the device tag (description).

Leak Sensitivity:

Possible options to choose:

- Normal (18 kOhm)
- High (30 kOhm)
- Low (14 kOhm)
- TT500x (10 kOhm)

Service Sensitivity:

Possible options to choose:

- Normal (50 uA)
- High (20 uA)
- Low (80 uA)
- TT500x (40 uA)
- Never

7.2 SIM UTILITY SETTINGS

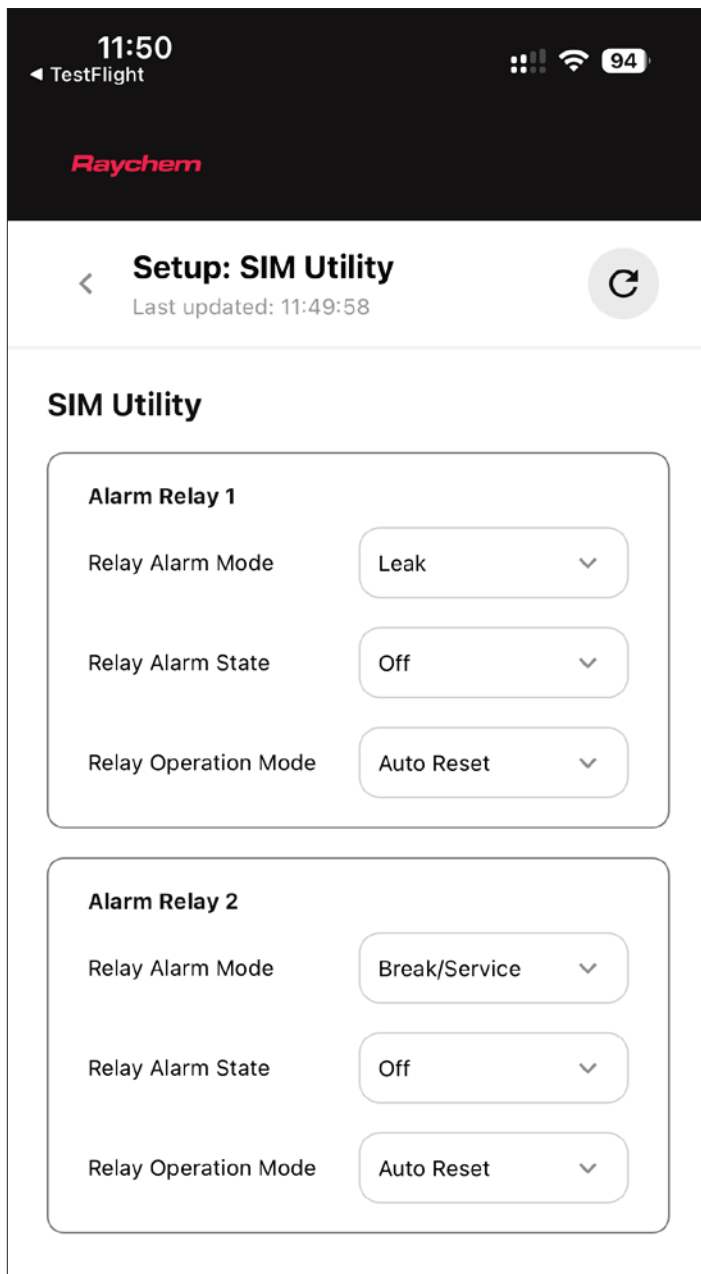

Figure 24: Temperature Sensor 1/2 Tab

SIM Utility

The SIM Utility screen presents the settings for Alarm Relay 1 and Alarm Relay 2.

Relay Alarm Mode

Relay Alarm Mode: The selectable values are shown below.

- Leak Only (Default setting for Relay 1. Triggers relay only on a Leak alarm)
- Service Only (Triggers relay only on a Service alarm condition)
- Break Only (Triggers relay only on a Cable Break alarm)
- Leak or Break (Triggers relay on a Leak or Cable Break alarm)
- Leak or Break or Service (Triggers relay on a Leak or Cable Break or Service alarm)
- Break or Service (Default setting for Relay 2. Triggers relay on a Cable Break or Service alarm)
- Always On (Test option used to energize the relay, regardless if the TTSIM is in normal or alarm condition)
- Always Off (Test option used to deenergize the relay, regardless if the TTSIM is in normal or alarm condition)

The factory default setting for Relay 1 = Leak Only and Relay2 = Break or Service. This allows maintenance personnel to distinguish between an urgent alarm that needs to be addressed immediately (i.e. a Leak), vs important notification that can be dealt with later (i.e. Break and Service).

Relay Alarm State

Select Off if you want the relay coil to be normally energized, then de-energized for alarms. Select On if you want the relay to be normally de-energized, then energized for alarms. The factory default value is Off. This is also commonly known as a fail-safe mode, because the relay will switch state even during a loss of power event as well as an alarm event.

Relay Operation Mode

This parameter defines how the TTSIM alarm relay is reset and has the following choices:

- Auto: The relay will automatically reset when the alarm condition is cleared. This is the factory default setting for Relay 1 and Relay 2.
- Manual: The relay will remain latched and reset only when either the Relay Reset button is pushed on the TTSIM-3/4 or the Acknowledge key is pressed on the TTDM-128 or TT-TS12 panel. The relay will reset regardless of the current alarm condition.
- Safe: The relay will reset only when the alarm condition has been cleared and either the Relay Reset button is pushed on the TTSIM-3/4 or the Acknowledge key is pressed on the TTDM-128 or TT-TS12 panel.

7.3 COMMUNICATION SETTINGS

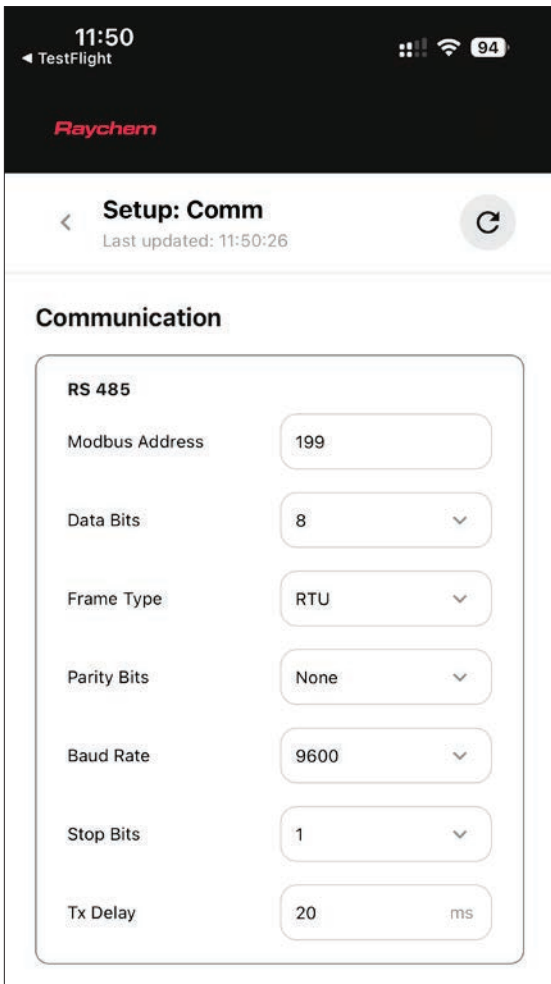
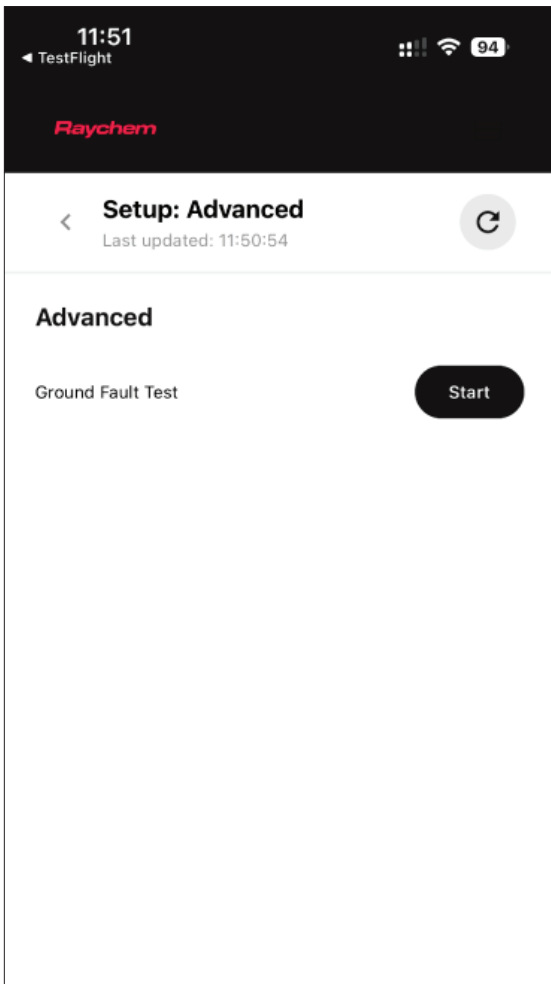

Figure 25: Temperature Source Tab

RS-485 communication parameters are software configurable in TTSIM-3 and TTSIM-4:

- Modbus address: range of 1 to 255
- Data bits: 7 / 8 (default)
- Frame Type: ASCII / RTU (default)
- Parity Bits: None (default) / Odd / Even
- Baud rate: 9600 (default) / 19200 / 38400 / 57600 / 115200
- Stop bits: 1 (default) / 2
- Transmission delay: range of 1 - 20 ms (default: 20 ms)

7.4 ADVANCED SETTINGS



On this page you can perform a Ground Fault test.

Figure 26: Advanced settings

7.5 IMPORT / EXPORT CONFIGURATION

The Import and Export buttons at the bottom of the navigation bar allows the user to Import/Export configuration parameters to or from the device as well allows downloading of monitoring data of the device. During configuration imports, the following fields will not be imported: Modbus Address and Device Tag.

SECTION 8 – BLUETOOTH SECURITY

8.1 BLUETOOTH® SECURITY

TTSIM3/4 devices can have Bluetooth communication protected by password security. By default, the Device is not secured. A secured Device can be in a locked or unlocked state. When the Device is locked, a lock icon will be visible beside the device name.

8.1.1 Enabling Bluetooth® Security

To enable Bluetooth® Security, select the specific device, click Settings and then slide the Security toggle to the right (**Fig 27**). This will pop up the Create Password Screen (**Fig 28**).

To set up Bluetooth® Security, enter a matching password in the two fields and click Set Password. Make sure “Enable Bluetooth® Security” is enabled.

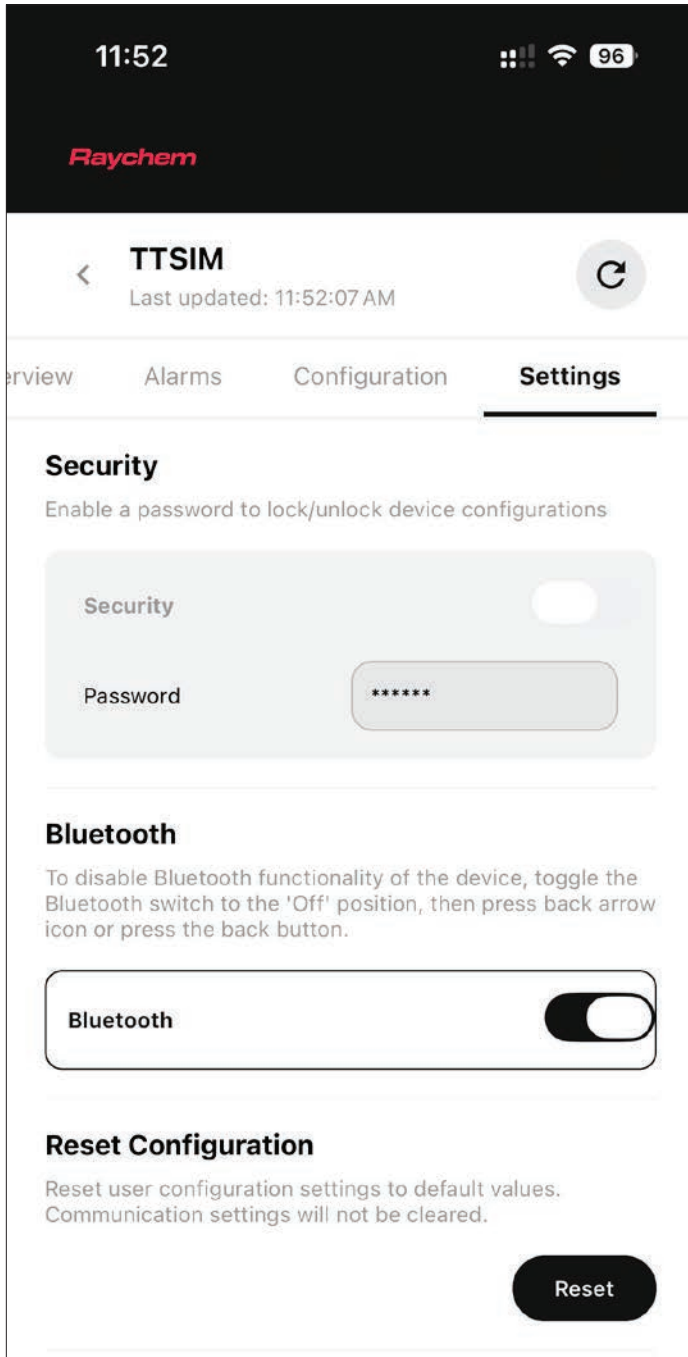

Figure 27: Enable Bluetooth Security Screen

Once the security is setup, if a device is locked, you will be able to read values using the app but will not be able to change any values. To remove Bluetooth Security, slide the Security toggle to the left.

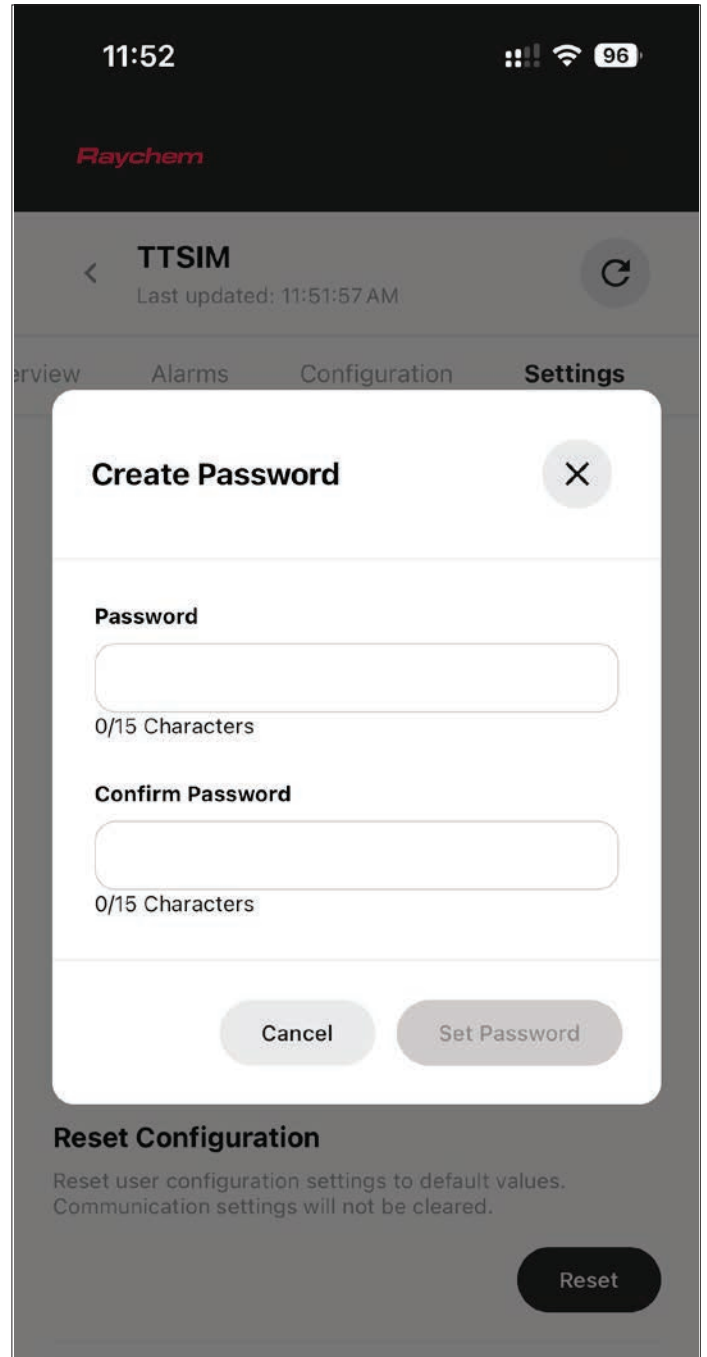

Figure 28: Enable Bluetooth Security Password Screen

8.1.2 Unlocking a Device

There are three ways to open the sign in popup screen to unlock the device.

- Click the Lock Icon on the top of the screen and you will be prompted asking you to change to unlock the device. Enter the password and click on the Unlock button (**Fig 29**).
- Try to change any of the values with a white background and you will be prompted asking you to unlock the device. Enter the password and click on the Unlock button (**Fig 29**).
- Navigate to the Settings tab of the device and click on Security (**Fig 30**). The Unlock device screen will display. Enter the password and click on the Unlock button (**Fig 30**).

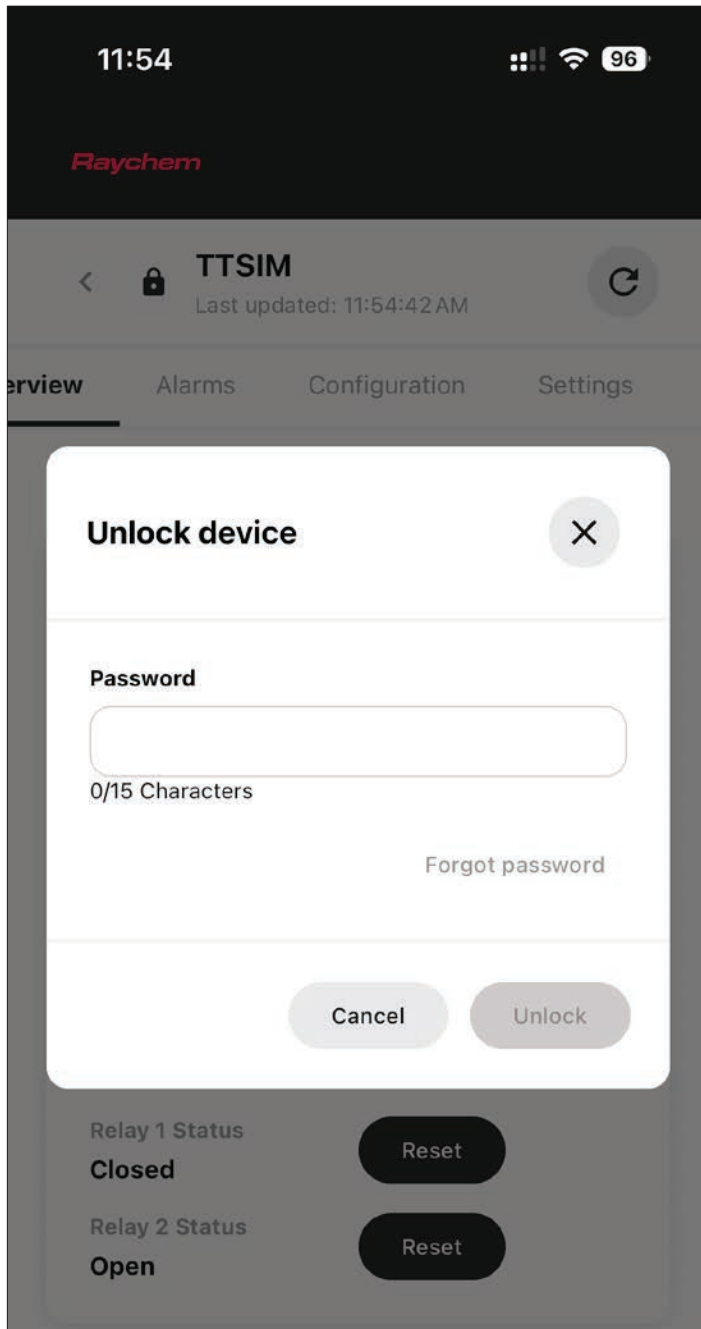

Figure 29: Device Unlock using Lock Icon / Changing Values

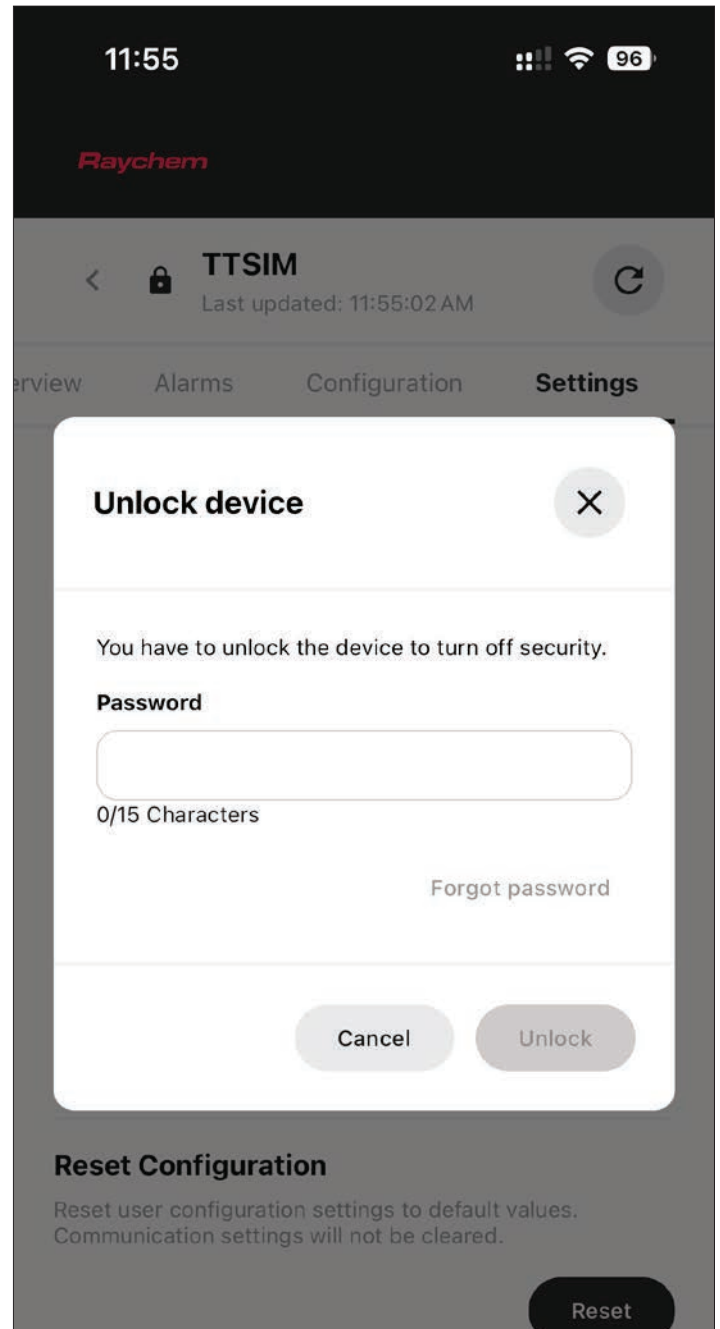

Figure 30: Device Unlock using Settings Tab

Once you have unlocked the device, you will be able to write but if you close the app or leave the Device Screen, the security will be activated again.

8.1.3 Reset Device

If you have forgotten your password, you can request to reset your password. This will generate a key which you will have to send to Chemelex Customer Support who will in return give you a code which will reset your security on your device. Reset Code List (**Fig 31**), which is shown in the Reset Device Screen will display the reset codes for your devices that you requested for. These keys will only last 48 hours, where, 24 hours after the first key was generated, a new one will be generated if you request again.

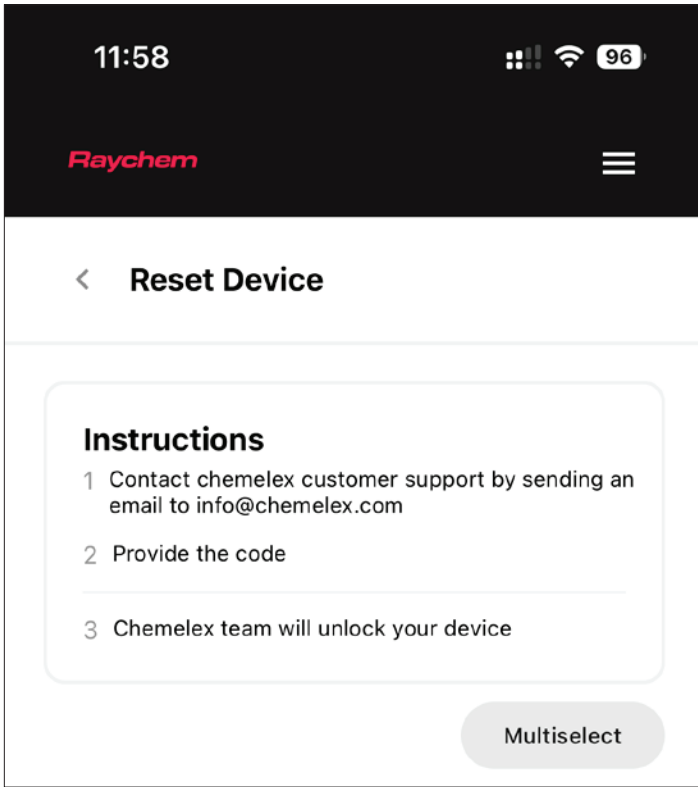

Figure 31: Reset Code List Screen

North America

Tel +1 800 545 6258
info@chemelex.com

Latin America

Tel +1 713 868 4800
info@chemelex.com

Europe, Middle East, Africa, India

Tel +32 16 213 511
Fax +32 16 213 604
info@chemelex.com

Asia Pacific

Tel +86 21 2412 1688
infoAPAC@chemelex.com



Raychem Tracer Pyrotenax Nuheat